

THE Beacon

A Newsletter for Lighthouse Ministries, Inc.

April 2008

www.ChangedLivesForALifetime.com



MESSAGE FROM THE EXECUTIVE DIRECTOR

NO DOWN TIME

Dear Friends ,

Wow this year has flown by quickly.

There is usually a down time after Christmas, but not this year.

We are growing like crazy. There is a definite increase in need that God is helping us to meet. Please pray with us regarding expanding the ministry. We have outgrown our current facility. There are plans in the making to meet the growing need. The vision for the Rachel House is still a reality. This is the vision that burns in my heart every day. We must buy property

and build a multi-purpose building to feed at least 200 people (*see architect's rendering on the back*). Then we can use our current facility to house up to 20 men at The Nehemiah House. The transition house—outside of downtown—where five men are currently staying is being bought by the city. The house will be torn down and the men living there will need to relocate. We have a building in mind that is close to us. The asking price for the 5-plex is \$130,000. It is a great buy, so please keep us in your prayers.

God Bless,

A handwritten signature in black ink that reads "Tay".

Tay Henderson, *Executive Director*

TAX REFUND? WE NEED YOUR HELP.

Please use the enclosed envelope or go online to www.thelighthouseministries.org to make a tax-deductible donation.

POST OFFICE FOOD DRIVE

when: Saturday, May 10, 2008

where: We have been assigned to collect food brought into the Garden Springs Post Office. We will show our gratitude in the form of snacks for the carriers when they come back to the station. Don't forget to leave non-perishables on your mailbox for your carrier to collect.



Proverbs 3:31-32 (NIV)

Do not envy a violent man or choose any of his ways, for the LORD detests a perverse man but takes the upright into his confidence.

The Lighthouse Ministries, Inc.

P.O. Box 54494

185 Elm Tree Lane

Lexington, KY 40555

Phone: 859-259-3434

Fax: 859-226-9362

E-mail: lighthouseministries@windstream.net

www.thelighthouseministries.org

Alcoholics Victorious Meetings

All are welcome! Please come!

Tuesday: 8 p.m.

Thursday: 6 p.m. dinner

7 p.m. class

8 p.m. meeting

Wednesday Bible Study &

Kids Club

6:15 p.m.—Kids Club for ages

5–12 is sponsored by Calvary

Chapel of the Bluegrass

Thursday Night Study

6:30 p.m.—8 p.m.

The Quest for Authentic

Manhood by Robert Lewis,

facilitated by Adam Smith,

Board Member and member

of Northeast Christian Church

Friday Morning Bible Study

10:30 a.m.—Led by Brother Ed

COUNTING OUR BLESSINGS

2007 GRATITUDE LIST

1. Opened the transition house on Meadow Park—presently at full capacity.
2. Built a prayer room in the basement.
3. Douglas Park outreach in June. We ministered with several local ministries to about 500 men, women and children. Ministries involved were The Lexington Rescue Mission, Youth for Christ, Grace Christian Center, Crossroads Christian Church, and Northeast Christian Church.
4. Grace Christian Center sponsored a golf scramble in July, they raised \$4000.
5. On November 3th the Southland Singles group sponsored the 3rd Annual Charity dance and live and silent auction at Good Ol Days Bar-B-Q. They raised \$10,000.
6. We joined the Association of Gospel Rescue Mission. We were able to be a part of the Hunger to Hope Campaign with K-Love and Air 1. We paid a \$500 registration fee and received about \$4000.
7. Joined with Bethel Harvest Church for Thanksgiving at The Charles Young Community Center. There were about 400–500 people present. 50 people received prayer for salvation or different needs in their lives. We sent out follow-up cards.
8. Started the series “Quest for Authentic Manhood” by Robert Lewis, facilitated by Adam Smith. It has been an excellent choice of teaching material.
9. Bluegrass Real Estate Weekly featured Roger Browning and because of him being a Board Member with the Lighthouse they raised \$500 to help with our annual Christmas Dinner.
10. Our annual Christmas Party was held at First United Methodist Church on High St. It was a great success. We had 250 men, women and children. We had about 60 volunteers. We took Polaroid pictures of the children with Santa Claus.
11. The Lexington Herald-Leader did an article about the shortage of food and the increase of the need to feed people. They featured us in the paper 12/10/07. We received an outpouring of donations.
12. Started our building committee and are pleased to have new people on board. Jim and Jamie Templin, are chairing the committee. Bill & Jackie Powell from the Serif Group are the lead and support for marketing and public relations.

UPCOMING EVENTS

April 8: Graduation for Joey Woodrum at 7 p.m. at The Lighthouse

April 19: The friends of The Lighthouse are sponsoring Billy Blues & Barbecue Spring Hootenanny dinner and dance at Good Ol' Days Barbecue, 544 Old Frankfort Pike in Midway, KY. Party starts at 7 p.m., tickets are \$20—and all proceeds go to Lighthouse Ministries. Please bring a bag of non-perishables.

April 25: The Covenant Players will perform a drama at noon at The Lighthouse.

April 25–27: Tattoo artist Robert Kinman from Pikeville, Ky, and his employees are coming to paint a mural on the side of The Lighthouse building.

May 10: Annual Post Office Food Drive

Stats

January–March 2008

- 8,000 meals served
- 793 volunteers
- 9 salvations
- 85 people prayed for
- 15 rededications
- 25 counseled
- 495 pieces of clothing distributed
- 30 blankets given away
- 200 breads & donuts given away

Alcoholics Victorious Meeting
attendance: 360

Men's prayer breakfast
attendance: 93

Average attendance at Brother Ed's Friday Bible Study: 10

ON-GOING NEEDS Call 859-259-3434 if you can help!

Paper plates, cups and bowls	Salmon	Chile beans	Sugar packets
Paper towels	Chicken	Tomato sauce	Cake mixes
Serving gloves	Lunch Meat	Diced Tomato	Brownie mixes
Lysol cleaner	Sloppy joe mix	Canned fruit	Icing
Bleach	Milk	Peanut Butter	Mayonnaise
Washing powder	Eggs- fresh, powder	Relish	Bread, buns, pastries
Meat- canned or fresh	Dry beans	Ranch dressing	
Tuna	Onions	Coffee	
	Crackers	Creamer packers	

Board of Directors
John Williams,
Chairman of the Board
Valerie "Tay" Henderson,
Executive Director
Mary Ann McMurry
Stephanie Grimes
Gary Thompson
Roger Browning
Adam Smith
Vivian Hammons



YOUTH GROUPS HELP OUT

SPRING BREAK AT LHM



On March 31 and April 1, the youth group from Southern Acres Christian Church volunteered at the Lighthouse. They spread 25 tons of much-needed gravel in the parking area, picked up trash in the neighborhood, worked in the food pantry and sorted clothes. Thank you so much for your help!

LIGHTHOUSE LAUNCHES FUNDRAISING INITIATIVE TO

MEET THE VISION

Our vision is to purchase the property next door at the corner of Elm Tree Lane and Corral Street, demolish existing structures, and build a multi-purpose facility from which to feed 200–250 people. The new building would have:

- Commercial kitchen
- Meeting space
- Offices

The current facility would then be able to house 20 men as The Nehemiah House, with plans in the future to develop The Rachel House a faith-based recovery program for women.

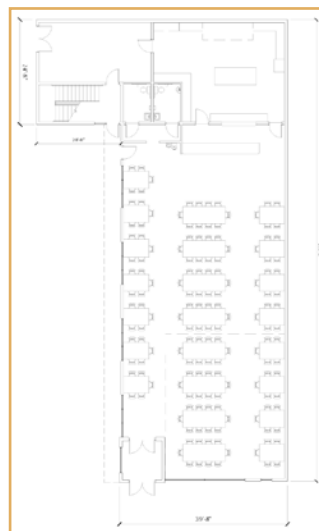

We appreciate all donations.

185 Elm Tree Lane • Lexington, KY 40555
859-259-3434 • www.changedlivesforalifetime.com